

LEGEND

---	PROPERTY LINE
---	PROPOSED PROPERTY LINE
AC PAVE	ASPHALT CONCRETE PAVEMENT
AD	AREA DRAIN
AR	ACCESS RAMP
CB	CATCH BASIN
CO	CLEANOUT
COL	COLUMN
CONC	CONCRETE
CW	CONCRETE WALL
EM	ELECTRIC METER
EP	EDGE OF PAVEMENT
FF	FINISH FLOOR
FH	FIRE HYDRANT
FL	FLOWLINE
FP	FINISH PAVE
GA	GUY ANCHOR
GM	GAS METER
GS FF	GARAGE SLAB FINISH FLOOR
ICV	IRRIGATION CONTROL VALVE
INV	INVERT
JP	JOINT UTILITY POLE
LG	LIP OF GUTTER
LP	LIGHT POLE
RW	ROCK WALL
SDMH	STORM DRAIN MANHOLE
SSMH	SANITARY SEWER MANHOLE
TC	TOP OF CURB
TW	TOP OF WALL
WM	WATER METER
WV	WATER VALVE
WW	WOOD WALL
●	TREE WITH SIZE & ARBORIST NUMBER
✕	EXISTING TREE PROPOSED TO BE REMOVED
-X-X-	FENCE
---JT---	JOINT TRENCH LINE
---OH---	OVERHEAD UTILITY LINE
---SS---	SANITARY SEWER LINE
---SD---	STORM DRAIN LINE
---W---	WATER LINE
---FM---	FORCE MAIN LINE

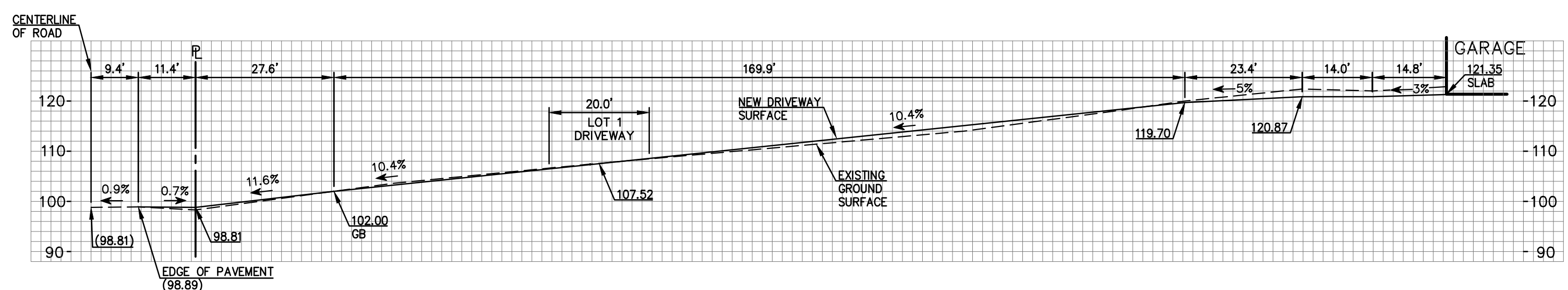

A DRIVEWAY C PROFILE
SCALE: 1"=20' (V & H)

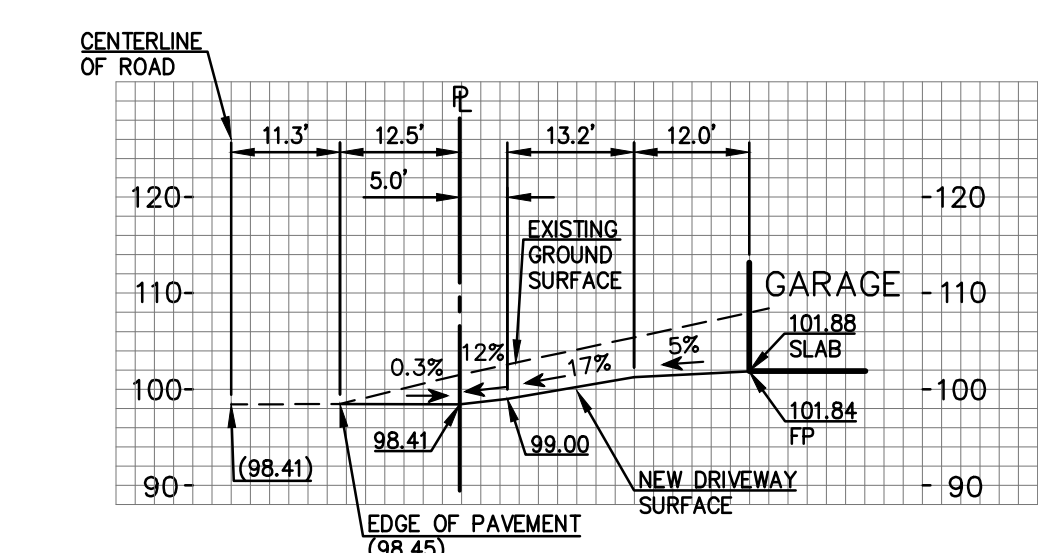

B DRIVEWAY C PROFILE
SCALE: 1"=20' (V & H)

APPROXIMATE GRADING QUANTITIES:

	CUT	FILL
LOT 1 & 2 DRIVEWAY	530	--
LOT 3 DRIVEWAY	320	--
TOTAL	850	--

TOTAL EARTHWORK = 850 C.Y. ±

OWNER / SUBDIVIDER:

APPLEWOOD INVESTMENTS LLC
1001 EL CAMINO REAL
MENLO PARK, CA 94025

CIVIL ENGINEER / LAND SURVEYOR:

DAN MacLEOD
MacLEOD & ASSOCIATES, INC.
965 CENTER STREET
SAN CARLOS, CA 94070
TEL: (650) 593-8580

EXISTING & PROPOSED LAND USE:

SINGLE FAMILY RESIDENTIAL

EXISTING & PROPOSED ZONING:

RH/DR

FLOOD ZONE:

ZONE "X"

ASSESSOR'S PARCEL NUMBER:

058-272-120

LOT AREA:

= 44,721 S.F. ±
= 1.027 ACRES. ±

AVERAGE LOT SLOPES:

LOT 1 AVERAGE SLOPE = 15.7%
LOT 2 AVERAGE SLOPE = 16.3% (NET AREA)
LOT 3 AVERAGE SLOPE = 18.1%

UTILITY SERVICES:

GAS & ELECTRICITY: PACIFIC GAS & ELECTRIC COMPANY
SANITARY SEWER: CITY OF REDWOOD CITY
WATER: CITY OF REDWOOD CITY
TELEPHONE: AT & T
FIRE PROTECTION: REDWOOD CITY FIRE DEPARTMENT

UTILITY NOTE:

THE UTILITIES EXISTING ON THE SURFACE AND SHOWN ON THIS DRAWING HAVE BEEN LOCATED BY FIELD SURVEY. ALL UNDERGROUND UTILITIES SHOWN ON THIS DRAWING ARE FROM RECORDS OF THE VARIOUS UTILITY COMPANIES AND THE SURVEYOR/ENGINEER DOES NOT ASSUME RESPONSIBILITY FOR THEIR COMPLETENESS, INDICATED LOCATION, OR SIZE. RECORD UTILITY LOCATION SHOULD BE CONFIRMED BY EXPOSING THE UTILITY.

GENERAL NOTES:

- EXISTING CONTOUR INFORMATION IS BASED UPON A FIELD SURVEY PERFORMED BY MacLEOD & ASSOCIATES IN JULY OF 2021 AND SUPPLEMENTED IN JULY OF 2022.
- THE EXISTING SEPTIC TANK WILL BE REMOVED AND THE EXISTING SEPTIC LEACH LINES WILL BE ABANDONED.
- TREES REQUIRING REMOVAL FOR SUBDIVISION IMPROVEMENTS (DRIVEWAYS AND UTILITIES) ARE MARKED WITH AN X FOR REMOVAL. SPECIFIC DETAILS FOR ALL OTHER TREES TO BE RETAINED OR REMOVED FOR FUTURE HOME IMPROVEMENTS ON EACH LOT WILL BE PROVIDED BY THE LANDSCAPE ARCHITECT AND/OR PROJECT ARBORIST AT THE DESIGN REVIEW PHASE.

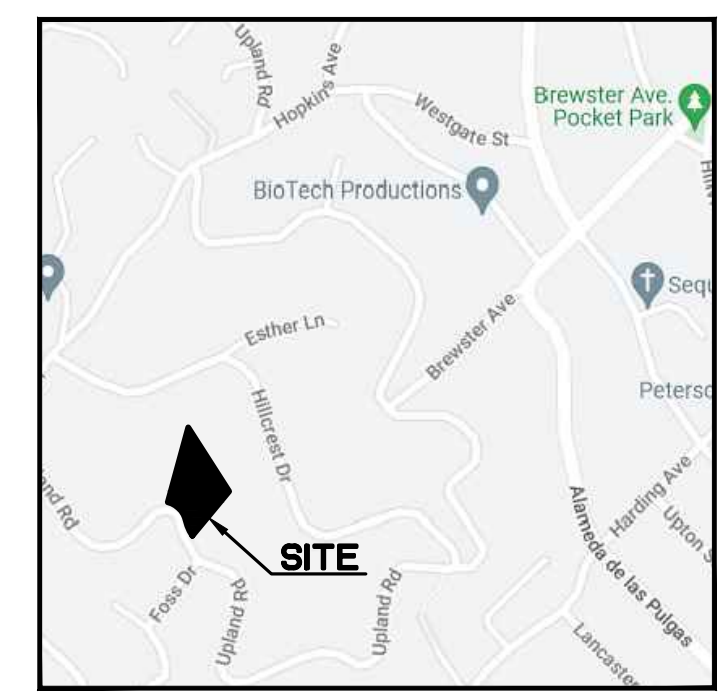

VICINITY MAP
NOT TO SCALE

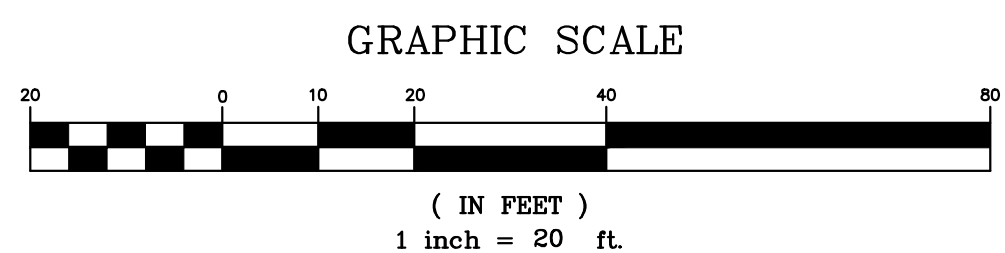

DATE: 07/14/23
BY: [Signature]
DESCRIPTION: [Blank]REV: [Blank]

PER COUNTY AND REDWOOD CITY COMMENTS: [Blank]

MacLEOD AND ASSOCIATES
CIVIL ENGINEERING • LAND SURVEYING
965 CENTER STREET • SAN CARLOS, CA 94070 • (650) 593-8580

PREPARED FOR: APPLEWOOD INVESTMENTS

VESTING TENTATIVE PARCEL MAP WITH PRELIMINARY GRADING & DRAINAGE

890 UPLAND ROAD
SAN MATEO COUNTY
CALIFORNIA
UNINCORPORATED

DRAWN BY: DJK
DESIGNED BY: DJK
CHECKED BY: DGM
SCALE: 1"=20'
DATE: 10-10-22
DRAWING NO. 5018-TM
SHEET 1 OF 2



SAN MATEO COUNTY STANDARD NOTES:

- EROSION CONTROL POINT OF CONTACT:
OWNER: PAUL GOSWAMY
EMAIL: GPS2001@COMCAST.NET
OFFICE: (650) 533-5800
- PERFORM CLEARING AND EARTH-MOVING ACTIVITIES ONLY DURING DRY WEATHER. MEASURES TO ENSURE ADEQUATE EROSION AND SEDIMENT CONTROL SHALL BE INSTALLED PRIOR TO EARTH-MOVING ACTIVITIES AND CONSTRUCTION
- STABILIZE ALL DENUDED AREAS AND MAINTAIN EROSION CONTROL MEASURES CONTINUOUSLY BETWEEN OCTOBER 1 AND APRIL 30.
- STORE, HANDLE, AND DISPOSE OF CONSTRUCTION MATERIALS AND WASTES PROPERLY, SO AS TO PREVENT THEIR CONTACT WITH STORMWATER.
- CONTROL AND PREVENT THE DISCHARGE OF ALL POTENTIAL POLLUTANTS, INCLUDING PAVEMENT CUTTING WASTES, PAINTS, CONCRETE, PETROLEUM PRODUCTS, CHEMICAL, WASH WATER OR SEDIMENTS AND NON-STORMWATER DISCHARGES TO STORM DRAINS AND WATERCOURSES.
- AVOID CLEANING, FUELING, OR MAINTAINING VEHICLES ON-SITE, EXCEPT IN A DESIGNATED AREA WHERE WASH WATER IS CONTAINED AND TREATED.
- LIMIT AND TIME APPLICATIONS OF PESTICIDES AND FERTILIZERS TO PREVENT POLLUTED RUNOFF.
- LIMIT CONSTRUCTION ACCESS ROUTES TO STABILIZED, DESIGNATED ACCESS POINTS.
- AVOID TRACKING DIRT OR OTHER MATERIALS OFF-SITE; CLEAN OFF-SITE PAVED AREAS AND SIDEWALKS USING DRY SWEEPING METHODS.
- TRAIN AND PROVIDE INSTRUCTION TO ALL EMPLOYEES AND SUBCONTRACTORS REGARDING THE WATERSHED PROTECTION MAINTENANCE STANDARDS AND CONSTRUCTION BEST MANAGEMENT PRACTICES.
- THE AREAS DELINEATED ON THE PLANS FOR PARKING, GRUBBING, STORAGE ETC., SHALL NOT BE ENLARGED OR "RUN OVER".
- CONSTRUCTION SITES ARE REQUIRED TO HAVE EROSION CONTROL MATERIALS ON-SITE DURING THE "OFF-SEASON".
- DUST CONTROL IS REQUIRED YEAR-ROUND.
- EROSION CONTROL MATERIALS SHALL BE STORED ON-SITE.
- USE OF PLASTIC SHEETING BETWEEN OCTOBER 1st. AND APRIL 30th IS NOT ACCEPTABLE, UNLESS FOR USE ON STOCKPILES WHERE THE STOCKPILE IS ALSO PROTECTED WITH FIBER ROLLS CONTAINING THE BASE OF THE STOCKPILE.

DUST CONTROL NOTES:

- WATER ALL CONSTRUCTION AND GRADING AREA AT LEAST TWICE DAILY.
- COVER ALL TRUCKS HAULING SOIL, SAND, AND OTHER LOOSE MATERIALS, OR REQUIRE ALL TRUCKS TO MAINTAIN AT LEAST 2 FEET OF FREEBOARD.

EROSION CONTROL NOTES:

- THE INTENT OF THE EROSION CONTROL PLAN IS TO MINIMIZE ANY WATER QUALITY IMPACTS IN THE FORM OF SEDIMENT POLLUTION TO MAIN CREEK & TRIBUTARIES.
- A CONSTRUCTION ENTRANCE WILL BE INSTALLED PRIOR TO OF GRADING. LOCATION OF THE ENTRANCE MAY BE ADJUSTED BY THE CONTRACTOR TO FACILITATE GRADING OPERATIONS. ALL CONSTRUCTION TRAFFIC ENTERING THE PAVED ROAD MUST CROSS THE CONSTRUCTION ENTRANCE. THE ENTRANCE SHALL BE MAINTAINED IN A CONDITION THAT WILL PREVENT TRACKING OR FLOWING OF SEDIMENT ONTO PUBLIC RIGHTS-OF-WAY. THIS MAY REQUIRE PERIODIC TOP DRESSING WITH ADDITIONAL STONE AS CONDITION DEMAND, AND REPAIR OF ANY MEASURES USED TO TRAP SEDIMENTS.
- WHEN NECESSARY, WHEELS SHALL BE CLEANED TO REMOVE SEDIMENT PRIOR TO ENTRANCE ONTO PUBLIC RIGHT-OF WAY. WHEN WASHING IS REQUIRED, IT SHALL BE DONE ON AN AREA STABILIZED WITH CRUSHED STONE WHICH DRAINS INTO AN APPROVED SEDIMENT BASIN. ALL SEDIMENT SHALL BE PREVENTED FROM ENTERING ANY STORM DRAIN, DITCH, OR WATERCOURSE THROUGH THE USE OF SAND BAGS, GRAVEL, BOARDS OR OTHER APPROVED METHODS.
- THE EROSION AND SEDIMENT CONTROL MEASURES WILL BE OPERABLE DURING THE RAINY SEASON, OCTOBER 1 TO APRIL 15. BY OCTOBER 1, GRADING AND INSTALLATION OF STORM DRAINAGE AND EROSION AND SEDIMENT CONTROL FACILITIES WILL BE COMPLETED. NO GRADING WILL OCCUR BETWEEN OCTOBER 1 AND APRIL 15 UNLESS AUTHORIZED BY THE CITY REPRESENTATIVE.
- DURING THE RAINY SEASON, ALL PAVED AREAS WILL BE KEPT CLEAR OF EARTH MATERIAL AND DEBRIS. THE SITE WILL BE MAINTAINED SO THAT A MINIMUM OF SEDIMENT-LADEN RUNOFF ENTERS THE STORM DRAINAGE SYSTEM.
- ALL EROSION AND SEDIMENTATION CONTROL MEASURES SHALL BE IN ACCORDANCE WITH THE LATEST EDITION OF THE EROSION AND SEDIMENT CONTROL FIELD MANUAL OF THE CALIFORNIA REGIONAL WATER QUALITY CONTROL BOARD.

DESIGN AND CONSTRUCTION SPECIFICATIONS FOR CONSTRUCTION ENTRANCE:

- THE MATERIAL FOR CONSTRUCTION OF THE PAD SHALL BE 4 TO 6 INCH FRACTURED AGGREGATE.
- THE THICKNESS OF THE PAD SHALL NOT BE LESS THAN 12 INCHES.
- THE WIDTH OF THE PAD SHALL NOT BE LESS THAN THE FULL WIDTH OF ALL POINTS OF INGRESS AND EGRESS.
- THE ENTRANCE SHALL BE MAINTAINED IN A CONDITION THAT WILL PREVENT TRACKING OR FLOWING OF SEDIMENT ONTO PUBLIC RIGHT-OF-WAY. THIS MAY REQUIRE PERIODIC TOP DRESSING WITH ADDITIONAL STONE AS CONDITIONS DEMAND, AND REPAIR AND/OR CLEANUP OF ANY MEASURES USED TO TRAP SEDIMENT. ALL SEDIMENT SPILLED, DROPPED, WASHED OR TRACKED ONTO PUBLIC RIGHTS-OF-WAY SHALL BE REMOVED IMMEDIATELY.
- WHEN WASHING IS REQUIRED, IT SHALL BE DONE ON AN AREA STABILIZED WITH CRUSHED STONE THAT DRAINS INTO AN APPROVED SEDIMENT TRAP OR SEDIMENT BASIN.

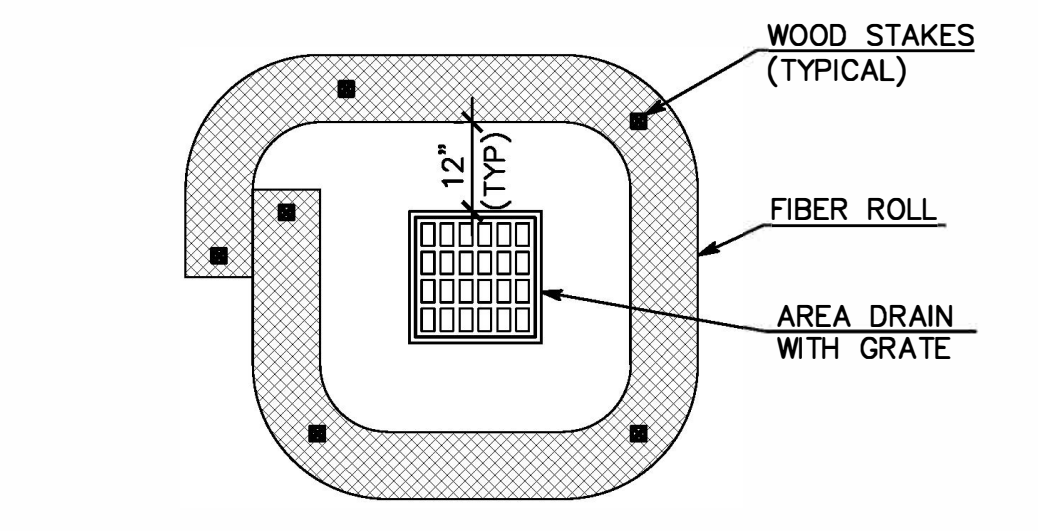

A DRAIN INLET PROTECTION DETAIL
SCALE: (NOT TO SCALE)

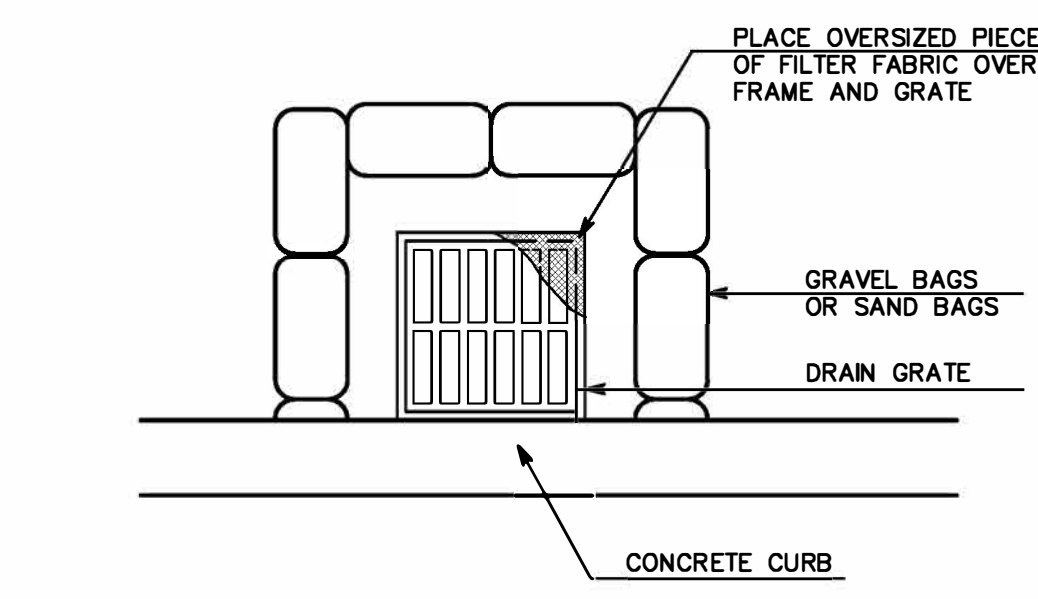

B DRAIN INLET PROTECTION DETAIL (OFF-SITE)
(NOT TO SCALE)

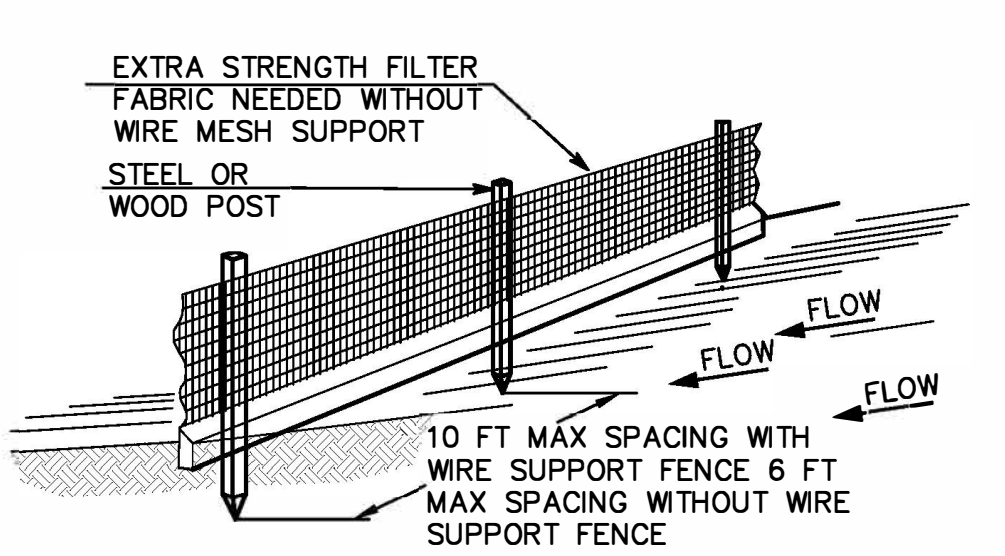
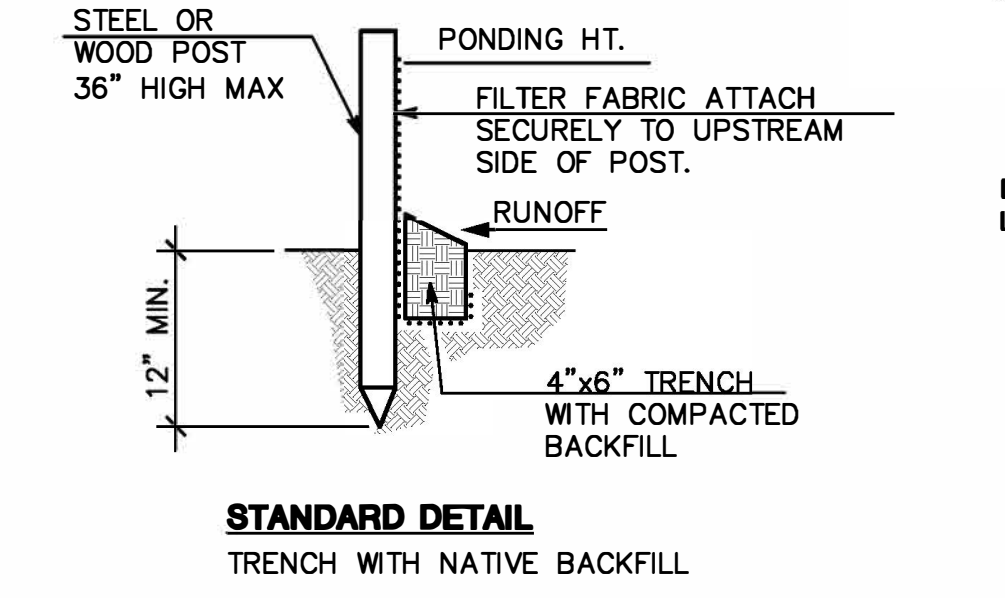

E SILT FENCE DETAIL
SCALE: (NOT TO SCALE)

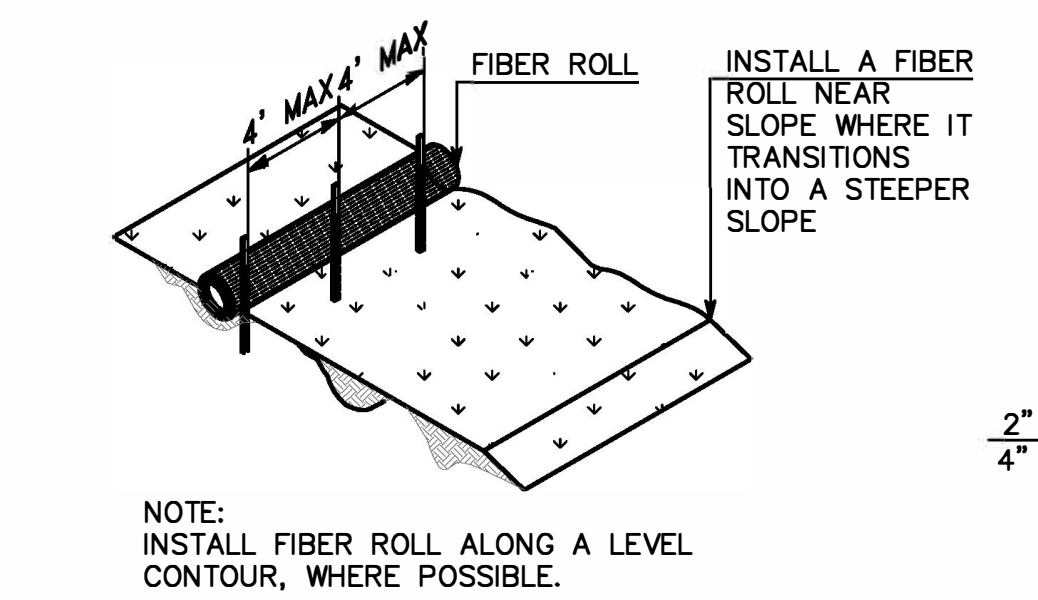

C TYPICAL FIBER ROLL INSTALLATION
N.T.S.

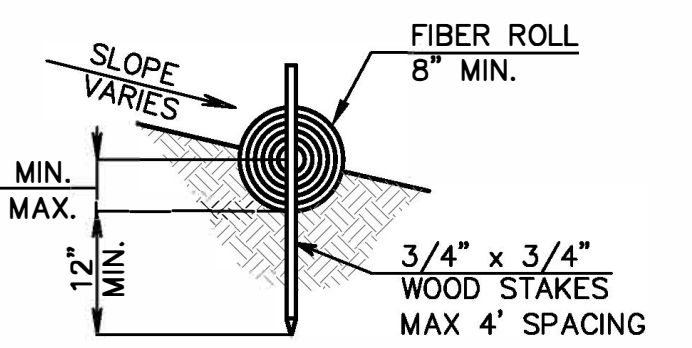

ENTRENCHMENT DETAIL
N.T.S.

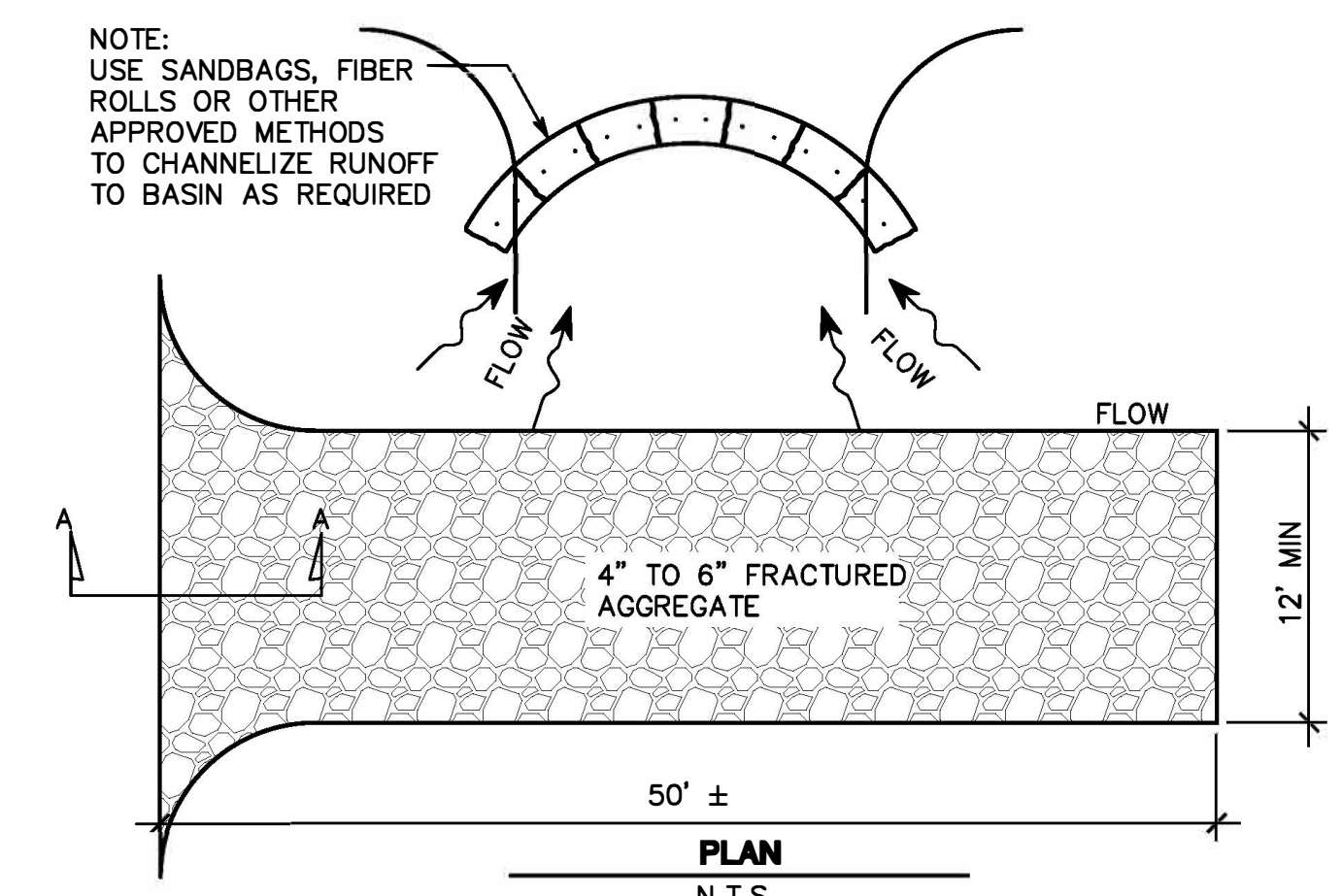

D CONSTRUCTION ENTRANCE DETAIL
SCALE: (NOT TO SCALE)

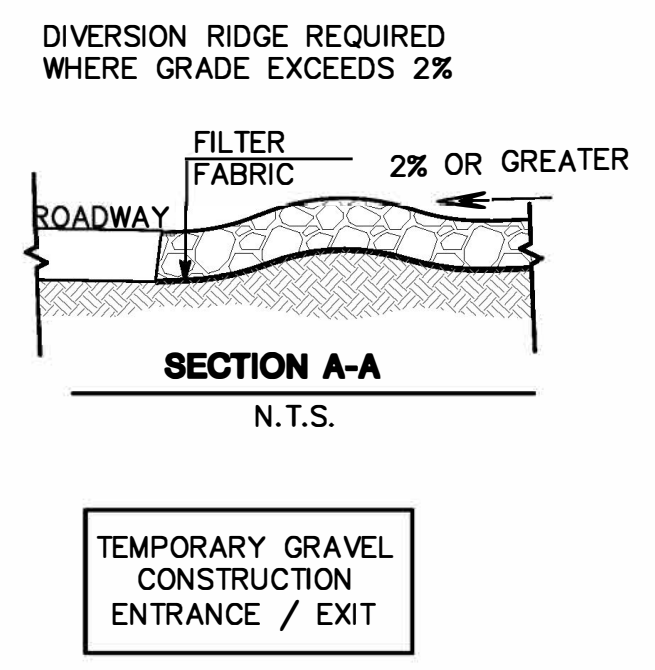

SECTION A-A
N.T.S.

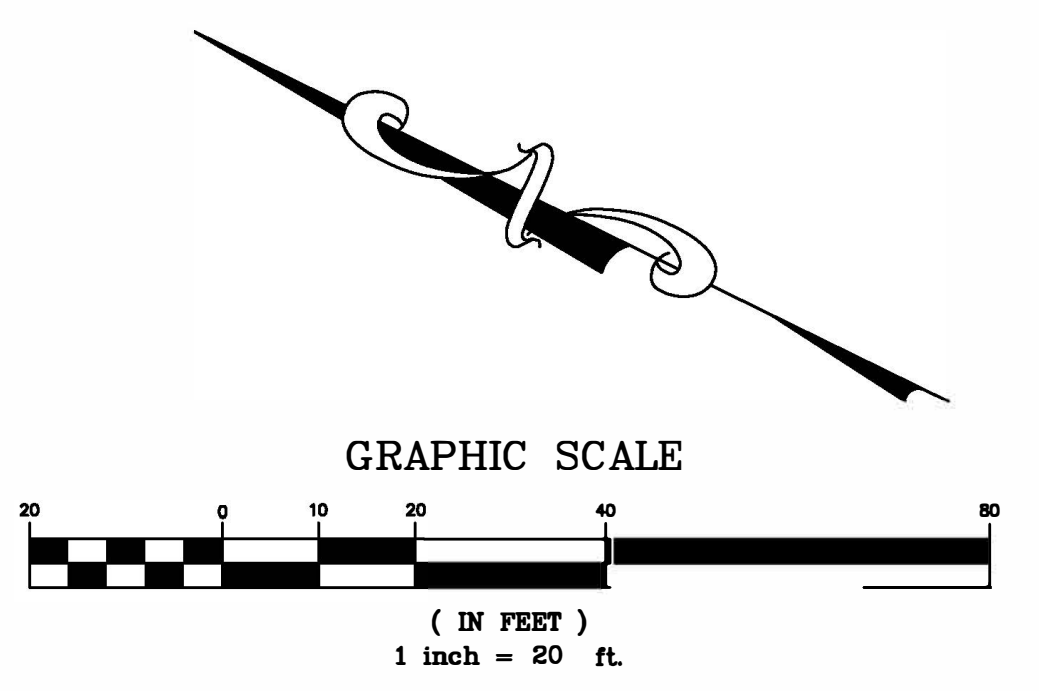

DATE: 07/14/23	BY: DJK
DESCRIPTION: PER COUNTY AND REDWOOD CITY COMMENTS	REV: 1
MACLEOD AND ASSOCIATES CIVIL ENGINEERING • LAND SURVEYING 965 CENTER STREET • SAN CARLOS, CA 94070 • (650) 593-8580	
PREPARED FOR: APPLEWOOD INVESTMENTS	CALIFORNIA
VESTING TENTATIVE PARCEL MAP EROSION & SEDIMENTATION CONTROL PLAN	UNINCORPORATED
890 UPLAND ROAD	SAN MATEO COUNTY
DRAWN BY: DJK	
DESIGNED BY: DJK	
CHECKED BY: DGM	
SCALE: 1"=20'	
DATE: 10-10-22	
DRAWING NO. 5018-TM	
SHEET 2 OF 2	